

● DVC (DUAL VOICE COIL) CONNECTION
● CONEXIÓN DE DVC (DOBLE BOBINA MÓVIL)

● CONNEXION DVC (DOUBLE BOBINE MOBILE)
● CONEXÃO DVC (BOBINA DE VOZ DUAL)

Connection Connexion Conexión	Speaker wiring Câblage des haut-parleurs Conexión de los alambres de los altavoces Ligações do altolaltante	Advantage Avantage Ventajas Vantagem	SEE VOIR VER VEJA
Bridged mono (Parallèle) Mono pontée (Parallèle) Sistema monofónico pondeado (Paralela) Mono em ponte (Paralelo)	Series Wiring Installation électrique des fils en série Instalación eléctrica en serie Fiação em série	Good for higher sensitivity Une sensibilité plus élevée Apropriado para una mayor sensibilidad Bom para maior sensibilidade	1
Stereo Stéréo Sistema estereofónico Estéreo	Paralel Wiring Installation électrique des fils en parallèle Instalación eléctrica en paralelo Fiação em paralelo	Good for higher sensitivity Une sensibilité plus élevée Apropriado para una mayor sensibilidad Bom para maior sensibilidade	1
Bridged mono Mono pontée Sistema monofónico pondeado Mono em ponte	Paralel Wiring Installation électrique des fils en parallèle Instalación eléctrica en paralelo Fiação em paralelo	Good for higher sensitivity Une sensibilité plus élevée Apropriado para una mayor sensibilidad Bom para maior sensibilidade Notice: Verify that your amplifier can operate in a 2 Ω mono configuration. Remarque: Vérifier que l'amplificateur peut fonctionner en configuration mono sous charge 2 Ω. Aviso: Asegúrese de que el amplificador puede ser operado en una configuración monofónica de 2 Ω. Nota: Verifique se o seu amplificador pode operar em configuração mono de 2 Ω.	2

⚠ CAUTION: Never connect only one voice coil of this Dual Voice Coil (DVC) speaker. Both voice coils must be connected to the amplifier for correct operation.
⚠ ATTENTION: Ne jamais connecter une seule bobine mobile de ce haut-parleur de Double Bobine Mobile (DVC). Les deux bobines doivent être connectées sur l'amplificateur afin d'assurer un fonctionnement correct.
⚠ PRECAUCIÓN: Nunca conecte una única bobina de altavoz Double Bobina Móvil (DVC). Se deben conectar ambas bobinas al amplificador para que funcione correctamente.
⚠ PRECAUÇÃO: Nunca ligue apenas um fio de voz deste altalante de Bobina de Voz Dual (DVC). Para um correcto funcionamento, ambos os fios têm de estar ligados ao amplificador.

● RECOMMENDED ENCLOSURE VOLUMES / PORT SIZES
● VOLUMENES DE LA CAJA / TAMAÑOS DE LAS PUERTAS RECOMENDADOS

● CONCEPTION POUR CAISSON / EVENT
● VOLUME DA CAIXA / TAMANHO DO ORIFÍCIO RECOMENDADOS

SEE VOIR VER VEJA	For Sealed Enclosure Pour caisson clos Para la caja sellada Para a caixa vedada	For Ported Enclosure Pour caisson transféré Para la caja puerta Para a caixa portado	For Bandpass Enclosure Pour caisson passe-bande Para la caja pasabanda Para a caixa pré-seletores																																			
1																																						
2																																						
RECOMMENDATION RECOMENDACIÓN RECOMENDAÇÃO	<table border="1"> <tr> <td>TS-W3001D4</td> <td>0.8 cu/ft (22.6 liters)</td> <td>TS-W3001D4</td> <td>1.2 cu/ft (34.0 liters)</td> <td>3" Dia. (Ø76 mm) × 3.5" (89 mm)</td> <td>TS-W3001D4</td> <td>1.0 cu/ft (28.3 liters)</td> <td>1.0 cu/ft (28.3 liters)</td> <td>3" Dia. (Ø76 mm) × 7" (178 mm)</td> </tr> <tr> <td>TS-W3001D2</td> <td>0.8 cu/ft (22.6 liters)</td> <td>TS-W3001D2</td> <td>1.2 cu/ft (34.0 liters)</td> <td>3" Dia. (Ø76 mm) × 3.5" (89 mm)</td> <td>TS-W3001D2</td> <td>1.0 cu/ft (28.3 liters)</td> <td>1.0 cu/ft (28.3 liters)</td> <td>3" Dia. (Ø76 mm) × 6.75" (171 mm)</td> </tr> </table>	TS-W3001D4	0.8 cu/ft (22.6 liters)	TS-W3001D4	1.2 cu/ft (34.0 liters)	3" Dia. (Ø76 mm) × 3.5" (89 mm)	TS-W3001D4	1.0 cu/ft (28.3 liters)	1.0 cu/ft (28.3 liters)	3" Dia. (Ø76 mm) × 7" (178 mm)	TS-W3001D2	0.8 cu/ft (22.6 liters)	TS-W3001D2	1.2 cu/ft (34.0 liters)	3" Dia. (Ø76 mm) × 3.5" (89 mm)	TS-W3001D2	1.0 cu/ft (28.3 liters)	1.0 cu/ft (28.3 liters)	3" Dia. (Ø76 mm) × 6.75" (171 mm)	<table border="1"> <tr> <td>TS-W2501D4</td> <td>0.6 cu/ft (17.0 liters)</td> <td>TS-W2501D4</td> <td>0.9 cu/ft (25.5 liters)</td> <td>3" Dia. (Ø76 mm) × 3.75" (95 mm)</td> <td>TS-W2501D4</td> <td>0.8 cu/ft (22.6 liters)</td> <td>0.8 cu/ft (22.6 liters)</td> <td>3" Dia. (Ø76 mm) × 8" (203 mm)</td> </tr> <tr> <td>TS-W2501D2</td> <td>0.6 cu/ft (17.0 liters)</td> <td>TS-W2501D2</td> <td>0.9 cu/ft (25.5 liters)</td> <td>3" Dia. (Ø76 mm) × 3.5" (89 mm)</td> <td>TS-W2501D2</td> <td>0.8 cu/ft (22.6 liters)</td> <td>0.8 cu/ft (22.6 liters)</td> <td>3" Dia. (Ø76 mm) × 7.75" (197 mm)</td> </tr> </table>	TS-W2501D4	0.6 cu/ft (17.0 liters)	TS-W2501D4	0.9 cu/ft (25.5 liters)	3" Dia. (Ø76 mm) × 3.75" (95 mm)	TS-W2501D4	0.8 cu/ft (22.6 liters)	0.8 cu/ft (22.6 liters)	3" Dia. (Ø76 mm) × 8" (203 mm)	TS-W2501D2	0.6 cu/ft (17.0 liters)	TS-W2501D2	0.9 cu/ft (25.5 liters)	3" Dia. (Ø76 mm) × 3.5" (89 mm)	TS-W2501D2	0.8 cu/ft (22.6 liters)	0.8 cu/ft (22.6 liters)	3" Dia. (Ø76 mm) × 7.75" (197 mm)
TS-W3001D4	0.8 cu/ft (22.6 liters)	TS-W3001D4	1.2 cu/ft (34.0 liters)	3" Dia. (Ø76 mm) × 3.5" (89 mm)	TS-W3001D4	1.0 cu/ft (28.3 liters)	1.0 cu/ft (28.3 liters)	3" Dia. (Ø76 mm) × 7" (178 mm)																														
TS-W3001D2	0.8 cu/ft (22.6 liters)	TS-W3001D2	1.2 cu/ft (34.0 liters)	3" Dia. (Ø76 mm) × 3.5" (89 mm)	TS-W3001D2	1.0 cu/ft (28.3 liters)	1.0 cu/ft (28.3 liters)	3" Dia. (Ø76 mm) × 6.75" (171 mm)																														
TS-W2501D4	0.6 cu/ft (17.0 liters)	TS-W2501D4	0.9 cu/ft (25.5 liters)	3" Dia. (Ø76 mm) × 3.75" (95 mm)	TS-W2501D4	0.8 cu/ft (22.6 liters)	0.8 cu/ft (22.6 liters)	3" Dia. (Ø76 mm) × 8" (203 mm)																														
TS-W2501D2	0.6 cu/ft (17.0 liters)	TS-W2501D2	0.9 cu/ft (25.5 liters)	3" Dia. (Ø76 mm) × 3.5" (89 mm)	TS-W2501D2	0.8 cu/ft (22.6 liters)	0.8 cu/ft (22.6 liters)	3" Dia. (Ø76 mm) × 7.75" (197 mm)																														
MAXIMUM MÁXIMUM MÁXIMA	<table border="1"> <tr> <td>TS-W3001D4</td> <td>1.0 cu/ft (28.3 liters)</td> <td>TS-W3001D4</td> <td>1.6 cu/ft (45.3 liters)</td> <td>3" Dia. (Ø76 mm) × 2.5" (64 mm)</td> <td>TS-W3001D4</td> <td>1.2 cu/ft (34.0 liters)</td> <td>1.2 cu/ft (34.0 liters)</td> <td>3" Dia. (Ø76 mm) × 5.5" (140 mm)</td> </tr> <tr> <td>TS-W3001D2</td> <td>1.0 cu/ft (28.3 liters)</td> <td>TS-W3001D2</td> <td>1.6 cu/ft (45.3 liters)</td> <td>3" Dia. (Ø76 mm) × 2.5" (64 mm)</td> <td>TS-W3001D2</td> <td>1.2 cu/ft (34.0 liters)</td> <td>1.2 cu/ft (34.0 liters)</td> <td>3" Dia. (Ø76 mm) × 5.25" (133 mm)</td> </tr> </table>	TS-W3001D4	1.0 cu/ft (28.3 liters)	TS-W3001D4	1.6 cu/ft (45.3 liters)	3" Dia. (Ø76 mm) × 2.5" (64 mm)	TS-W3001D4	1.2 cu/ft (34.0 liters)	1.2 cu/ft (34.0 liters)	3" Dia. (Ø76 mm) × 5.5" (140 mm)	TS-W3001D2	1.0 cu/ft (28.3 liters)	TS-W3001D2	1.6 cu/ft (45.3 liters)	3" Dia. (Ø76 mm) × 2.5" (64 mm)	TS-W3001D2	1.2 cu/ft (34.0 liters)	1.2 cu/ft (34.0 liters)	3" Dia. (Ø76 mm) × 5.25" (133 mm)	<table border="1"> <tr> <td>TS-W2501D4</td> <td>0.7 cu/ft (19.8 liters)</td> <td>TS-W2501D4</td> <td>1.2 cu/ft (34.0 liters)</td> <td>3" Dia. (Ø76 mm) × 2.5" (64 mm)</td> <td>TS-W2501D4</td> <td>1.0 cu/ft (28.3 liters)</td> <td>1.0 cu/ft (28.3 liters)</td> <td>3" Dia. (Ø76 mm) × 6.25" (159 mm)</td> </tr> <tr> <td>TS-W2501D2</td> <td>0.7 cu/ft (19.8 liters)</td> <td>TS-W2501D2</td> <td>1.2 cu/ft (34.0 liters)</td> <td>3" Dia. (Ø76 mm) × 2.5" (64 mm)</td> <td>TS-W2501D2</td> <td>1.0 cu/ft (28.3 liters)</td> <td>1.0 cu/ft (28.3 liters)</td> <td>3" Dia. (Ø76 mm) × 6" (152 mm)</td> </tr> </table>	TS-W2501D4	0.7 cu/ft (19.8 liters)	TS-W2501D4	1.2 cu/ft (34.0 liters)	3" Dia. (Ø76 mm) × 2.5" (64 mm)	TS-W2501D4	1.0 cu/ft (28.3 liters)	1.0 cu/ft (28.3 liters)	3" Dia. (Ø76 mm) × 6.25" (159 mm)	TS-W2501D2	0.7 cu/ft (19.8 liters)	TS-W2501D2	1.2 cu/ft (34.0 liters)	3" Dia. (Ø76 mm) × 2.5" (64 mm)	TS-W2501D2	1.0 cu/ft (28.3 liters)	1.0 cu/ft (28.3 liters)	3" Dia. (Ø76 mm) × 6" (152 mm)
TS-W3001D4	1.0 cu/ft (28.3 liters)	TS-W3001D4	1.6 cu/ft (45.3 liters)	3" Dia. (Ø76 mm) × 2.5" (64 mm)	TS-W3001D4	1.2 cu/ft (34.0 liters)	1.2 cu/ft (34.0 liters)	3" Dia. (Ø76 mm) × 5.5" (140 mm)																														
TS-W3001D2	1.0 cu/ft (28.3 liters)	TS-W3001D2	1.6 cu/ft (45.3 liters)	3" Dia. (Ø76 mm) × 2.5" (64 mm)	TS-W3001D2	1.2 cu/ft (34.0 liters)	1.2 cu/ft (34.0 liters)	3" Dia. (Ø76 mm) × 5.25" (133 mm)																														
TS-W2501D4	0.7 cu/ft (19.8 liters)	TS-W2501D4	1.2 cu/ft (34.0 liters)	3" Dia. (Ø76 mm) × 2.5" (64 mm)	TS-W2501D4	1.0 cu/ft (28.3 liters)	1.0 cu/ft (28.3 liters)	3" Dia. (Ø76 mm) × 6.25" (159 mm)																														
TS-W2501D2	0.7 cu/ft (19.8 liters)	TS-W2501D2	1.2 cu/ft (34.0 liters)	3" Dia. (Ø76 mm) × 2.5" (64 mm)	TS-W2501D2	1.0 cu/ft (28.3 liters)	1.0 cu/ft (28.3 liters)	3" Dia. (Ø76 mm) × 6" (152 mm)																														
MINIMUM MÍNIMUM MÍNIMA	<table border="1"> <tr> <td>TS-W3001D4</td> <td>0.5 cu/ft (14.2 liters)</td> <td>TS-W3001D4</td> <td>0.8 cu/ft (22.6 liters)</td> <td>3" Dia. (Ø76 mm) × 7" (178 mm)</td> <td>TS-W3001D4</td> <td>0.8 cu/ft (22.6 liters)</td> <td>0.8 cu/ft (22.6 liters)</td> <td>3" Dia. (Ø76 mm) × 9" (229 mm)</td> </tr> <tr> <td>TS-W3001D2</td> <td>0.5 cu/ft (14.2 liters)</td> <td>TS-W3001D2</td> <td>0.8 cu/ft (22.6 liters)</td> <td>3" Dia. (Ø76 mm) × 7" (178 mm)</td> <td>TS-W3001D2</td> <td>0.8 cu/ft (22.6 liters)</td> <td>0.8 cu/ft (22.6 liters)</td> <td>3" Dia. (Ø76 mm) × 8.75" (222 mm)</td> </tr> </table>	TS-W3001D4	0.5 cu/ft (14.2 liters)	TS-W3001D4	0.8 cu/ft (22.6 liters)	3" Dia. (Ø76 mm) × 7" (178 mm)	TS-W3001D4	0.8 cu/ft (22.6 liters)	0.8 cu/ft (22.6 liters)	3" Dia. (Ø76 mm) × 9" (229 mm)	TS-W3001D2	0.5 cu/ft (14.2 liters)	TS-W3001D2	0.8 cu/ft (22.6 liters)	3" Dia. (Ø76 mm) × 7" (178 mm)	TS-W3001D2	0.8 cu/ft (22.6 liters)	0.8 cu/ft (22.6 liters)	3" Dia. (Ø76 mm) × 8.75" (222 mm)	<table border="1"> <tr> <td>TS-W2501D4</td> <td>0.35 cu/ft (9.9 liters)</td> <td>TS-W2501D4</td> <td>0.6 cu/ft (17.0 liters)</td> <td>3" Dia. (Ø76 mm) × 7" (178 mm)</td> <td>TS-W2501D4</td> <td>0.6 cu/ft (17.0 liters)</td> <td>0.6 cu/ft (17.0 liters)</td> <td>3" Dia. (Ø76 mm) × 11" (279 mm)</td> </tr> <tr> <td>TS-W2501D2</td> <td>0.35 cu/ft (9.9 liters)</td> <td>TS-W2501D2</td> <td>0.6 cu/ft (17.0 liters)</td> <td>3" Dia. (Ø76 mm) × 7" (178 mm)</td> <td>TS-W2501D2</td> <td>0.6 cu/ft (17.0 liters)</td> <td>0.6 cu/ft (17.0 liters)</td> <td>3" Dia. (Ø76 mm) × 10.75" (273 mm)</td> </tr> </table>	TS-W2501D4	0.35 cu/ft (9.9 liters)	TS-W2501D4	0.6 cu/ft (17.0 liters)	3" Dia. (Ø76 mm) × 7" (178 mm)	TS-W2501D4	0.6 cu/ft (17.0 liters)	0.6 cu/ft (17.0 liters)	3" Dia. (Ø76 mm) × 11" (279 mm)	TS-W2501D2	0.35 cu/ft (9.9 liters)	TS-W2501D2	0.6 cu/ft (17.0 liters)	3" Dia. (Ø76 mm) × 7" (178 mm)	TS-W2501D2	0.6 cu/ft (17.0 liters)	0.6 cu/ft (17.0 liters)	3" Dia. (Ø76 mm) × 10.75" (273 mm)
TS-W3001D4	0.5 cu/ft (14.2 liters)	TS-W3001D4	0.8 cu/ft (22.6 liters)	3" Dia. (Ø76 mm) × 7" (178 mm)	TS-W3001D4	0.8 cu/ft (22.6 liters)	0.8 cu/ft (22.6 liters)	3" Dia. (Ø76 mm) × 9" (229 mm)																														
TS-W3001D2	0.5 cu/ft (14.2 liters)	TS-W3001D2	0.8 cu/ft (22.6 liters)	3" Dia. (Ø76 mm) × 7" (178 mm)	TS-W3001D2	0.8 cu/ft (22.6 liters)	0.8 cu/ft (22.6 liters)	3" Dia. (Ø76 mm) × 8.75" (222 mm)																														
TS-W2501D4	0.35 cu/ft (9.9 liters)	TS-W2501D4	0.6 cu/ft (17.0 liters)	3" Dia. (Ø76 mm) × 7" (178 mm)	TS-W2501D4	0.6 cu/ft (17.0 liters)	0.6 cu/ft (17.0 liters)	3" Dia. (Ø76 mm) × 11" (279 mm)																														
TS-W2501D2	0.35 cu/ft (9.9 liters)	TS-W2501D2	0.6 cu/ft (17.0 liters)	3" Dia. (Ø76 mm) × 7" (178 mm)	TS-W2501D2	0.6 cu/ft (17.0 liters)	0.6 cu/ft (17.0 liters)	3" Dia. (Ø76 mm) × 10.75" (273 mm)																														

The recommended enclosure volumes include speaker displacement.
Les volumes de caisson recommandé comprennent le déplacement HP.
Los volúmenes encastrados recomendados incluyen el desplazamiento del altoparlante.
Os volumes encastrados recomendados incluem o deslocamento do alto-falante.

● CHARACTERISTICS ● CARACTERISTIQUES ● CARACTERÍSTICAS ● CARACTERÍSTICAS

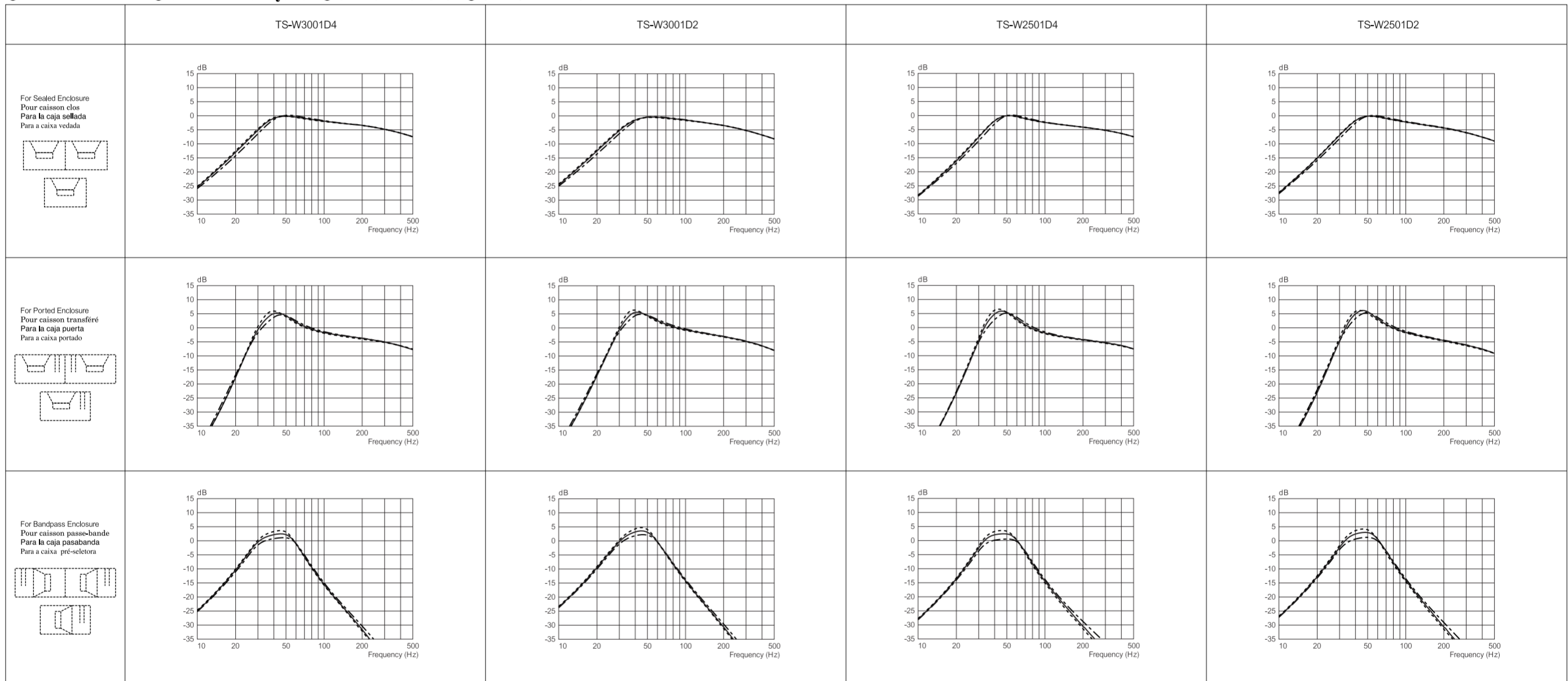

RECOMMENDED ENCLOSURE VOLUME VOLUME RECOMMANDÉ DU CAISSON DE L'ENCEINTE VOLUMEN DE LA CAJA RECOMENDADO VOLUME DA CAIXA RECOMENDADO
MAXIMUM ENCLOSURE VOLUME VOLUME MAXIMUM DU CAISSON DE L'ENCEINTE VOLUMEN MÁXIMO DE LA CAJA VOLUME MÁXIMO DA CAIXA
MINIMUM ENCLOSURE VOLUME VOLUME MINIMUM DU CAISSON DE L'ENCEINTE VOLUMEN MÍNIMO DE LA CAJA VOLUME MÍNIMO DA CAIXA

● SPECIFICATIONS ● CARACTERISTIQUES ● ESPECIFICACIONES ● ESPECIFICAÇÕES

Model Modèle Modelo Modelo	Size Taille Tamaño Tamanho	Nominal power Puissance nominale Potencia nominal Potência nominal	Maxmusic power Puissance musicale maximum Máxima potencia de música Potência máxima da música	Nominal impedance Impédance nominale Impedancia nominal Impedância nominal	Sensitivity Sensibilité Sensibilidad Sensibilidade	Frequency response Bande passante Respuesta de frecuencia Resposta de frequência	Magnet weight Poids aimant Peso del imán Peso do magneto	Displacement Déplacement Desplazamiento Deslocamento
TS-W3001D4	12" (30 cm)	1 000 W	3 000 W	dual 4 Ω	92 dB (in car. input: 1 W)	20 Hz To 150 Hz (in car. input: 1 W)	3 110 g (110 oz)	0.181 cu/ft 5.12 liters
TS-W3001D2	12" (30 cm)	1 000 W	3 000 W	dual 2 Ω	92 dB (in car. input: 1 W)	20 Hz To 150 Hz (in car. input: 1 W)	3 110 g (110 oz)	0.181 cu/ft 5.12 liters
TS-W2501D4	10" (25 cm)	800 W	2 500 W	dual 4 Ω	90 dB (in car. input: 1 W)	20 Hz To 150 Hz (in car. input: 1 W)	2 400 g (85 oz)	0.117 cu/ft 3.31 liters
TS-W2501D2	10" (25 cm)	800 W	2 500 W	dual 2 Ω	90 dB (in car. input: 1 W)	20 Hz To 150 Hz (in car. input: 1 W)	2 400 g (85 oz)	0.117 cu/ft 3.31 liters

Model Modèle Modelo Modelo	Revc (Ω)	Levc (mH) 8 Ω / 2 Ω	Zmax (Ω) 8 Ω / 2 Ω	Fs (Hz)	Qms	Qes	Qts	Vas (cu/ft) (liters)	Rms (N.S/m)	Mms (g)	Cms (m/N)	Diam (inch) (mm)	Sd (sq.in) (sq.cm)	BL (T.m) 8 Ω / 2 Ω	Xmax (inch) (mm)	Hvc (inch) (mm)	Hag (inch) (mm)
TS-W3001D4	dual 3.3	5.55 (8 Ω) Series wiring 1.39 (2 Ω) Parallel wiring	156.07 (8 Ω) Series wiring 46.54 (2 Ω) Parallel wiring	33.3	13.99	0.63	0.60	0.418 11.826	6.003	401.32	5.70 × 10 ⁻⁶	9.3	67.8 0.043 7	29.94 (8 Ω) Series wiring 15.12 (2 Ω) Parallel wiring	0.51 12.9	1.96 49.8	0.94 24
TS-W3001D2	dual 1.5	3.17 (4 Ω) Series wiring 0.79 (1 Ω) Parallel wiring	88.91 (4 Ω) Series wiring 22.28 (1 Ω) Parallel wiring	32.1	15.68	0.58	0.56	0.320 9.059	7.239	458.96	5.36 × 10 ⁻⁶	9.3	67.8 0.043 7	24.83 (4 Ω) Series wiring 11.27 (1 Ω) Parallel wiring	0.48 12.3	1.91 48.5	0.94 24
TS-W2501D4	dual 3.3	4.80 (8 Ω) Series wiring 1.20 (2 Ω) Parallel wiring	131.86 (8 Ω) Series wiring 35.26 (2 Ω) Parallel wiring	38.8	14.16	0.76	0.72	0.222 6.274	4.711	273.53	6.16 × 10 ⁻⁶	7.9	48.6 0.031 3	24.28 (8 Ω) Series wiring 11.97 (2 Ω) Parallel wiring	0.39 9.8	1.68 42.7	0.91 23
TS-W2501D2	dual 1.5	3.07 (4 Ω) Series wiring 0.76 (1 Ω) Parallel wiring	71.84 (4 Ω) Series wiring 18.13 (1 Ω) Parallel wiring	37.2	15.49	0.69	0.66	0.221 6.247	4.510	298.41	6.14 × 10 ⁻⁶	7.9	48.6 0.031 3	17.64 (4 Ω) Series wiring 9.12 (1 Ω) Parallel wiring	0.43 11.0	1.77 45.0	0.91 23

● HOW TO INSTALL ● MODE D'INSTALLATION ● INSTALACION ● COMO INSTALAR

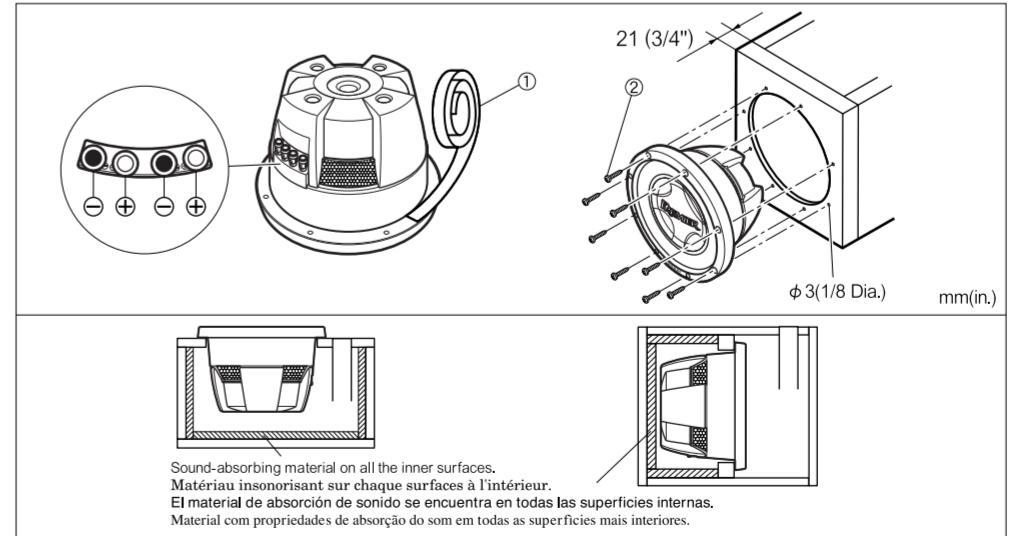

● PARTS INCLUDED ● PIECES COMPRISES ● PIEZAS INCLUIDAS ● PECAS INCLUIDAS

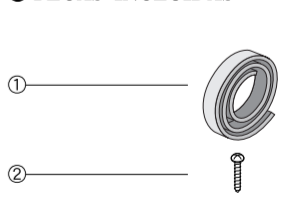

Register your product at
Enregistrez votre produit au
<http://www.pioneerelectronics.com>

